

Residential Vacant and Residential Land Value Indicators 2021

The Charter Township of Garfield
Grand Traverse County, Michigan



Legend

- Residential Sales
- Township Parcels

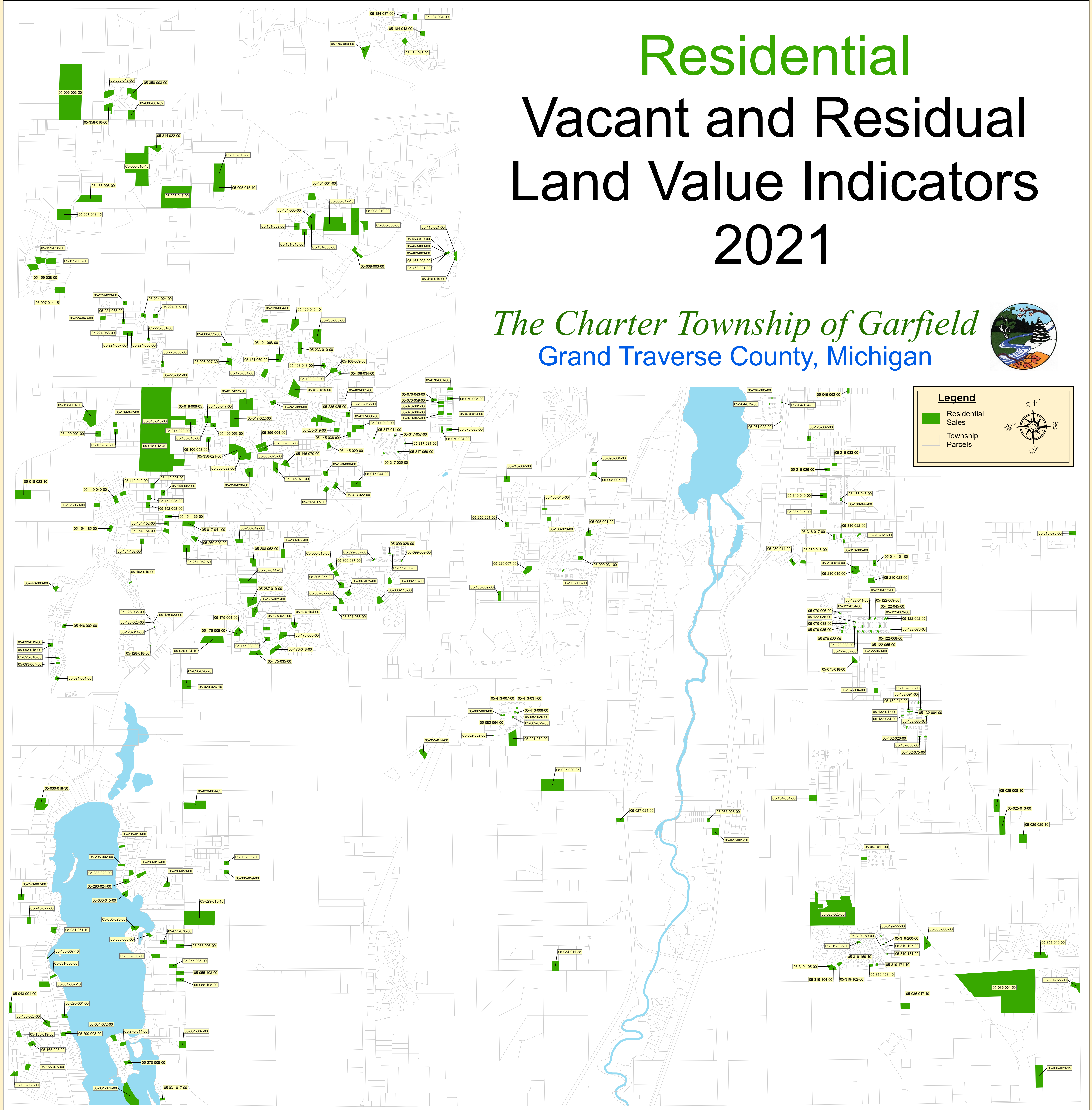

Parcel	Street Address	Sale Date	Sale Price	Acres	Price/SF	Parcel	Street Address	Sale Date	Sale Price	Acres	Price/SF	Parcel	Street Address	Sale Date	Sale Price	Acres	Price/SF	Parcel	Street Address	Sale Date	Sale Price	Acres	Price/SF						
05-005-015-40	JANUARY DR	11/11/21	\$200,000	1.614	\$2.84	05-055-095-00	885 N EAST SILVER LAKE RD	08/02/21	\$233,500	0.505	\$4.84	05-122-035-00	1122 HEMINGWAY LN	07/27/21	\$295,000	0.191	\$1,544.68	05-175-035-00	2674 BLUE RIDGE LN	10/02/21	\$437,400	0.921	\$6.35	05-305-062-00	1348 SILVERWOOD DR	09/10/21	\$297,900	0.333	\$1,212.21
05-005-015-50	JANUARY DR	11/11/21	\$200,000	4.226	\$1.09	05-055-103-00	737 N EAST SILVER LAKE RD	05/28/21	\$272,000	0.505	\$3.10	05-122-038-00	1134 HEMINGWAY LN	05/27/21	\$285,000	0.191	\$1,491.41	05-176-048-00	2555 WESTWARD DR	04/29/21	\$410,000	0.832	\$3.57	05-306-013-00	4381 STONERIDGE DR	04/28/21	\$550,000	0.443	\$5.59
05-006-001-02	BARNEY RD	10/19/21	\$93,000	1.211	\$50.33	05-055-105-00	699 N EAST SILVER LAKE RD	12/20/21	\$235,000	0.505	\$6.30	05-122-045-00	1199 HEMINGWAY LN	11/09/21	\$270,000	0.191	\$1,625.25	05-176-085-00	2616 WESTWARD DR	06/24/21	\$395,000	0.783	\$4.18	05-306-037-00	4382 STONERIDGE DR	04/23/21	\$465,000	0.382	\$1,210.34
05-006-003-20	BARNEY RD	04/20/21	\$160,000	24.107	\$5.15	05-055-105-00	2071 LARKRA DR	09/09/21	\$18,500	0.179	\$50.34	05-122-054-00	1159 HEMINGWAY LN	04/06/21	\$275,000	0.191	\$1,439.53	05-176-104-00	2652 N WALKER ST	07/15/21	\$395,000	0.488	\$8.52	05-306-057-00	4013 HIDDEN CREEK DR	07/16/21	\$480,000	0.442	\$1,086.40
05-006-016-40	BARNEY RD	10/21/21	\$415,000	12.607	\$50.26	05-070-001-00	3983 FRANKIE RD	11/09/21	\$195,000	0.189	\$14.97	05-122-057-00	1146 HEMINGWAY LN	09/29/21	\$320,000	0.191	\$1,718.11	05-180-107-00	722 N WEST SILVER LAKE RD	04/12/21	\$490,000	0.058	\$73.47	05-307-068-00	4103 STONERIDGE DR	12/03/21	\$565,000	0.381	\$1,515.60
05-006-017-00	5065 HARRIS RD	04/21/21	\$145,000	13.130	\$9.46	05-070-005-00	3923 FRANKIE RD	07/30/21	\$160,000	0.189	\$9.12	05-122-060-00	1158 HEMINGWAY LN	05/14/21	\$276,000	0.191	\$1,279.79	05-184-018-00	876 INCOCHEE WOODS DR	03/31/21	\$122,000	0.423	\$6.62	05-307-072-00	4074 STONERIDGE DR	11/15/21	\$380,000	0.368	\$6.96
05-007-013-13	CEDAR RUN RD	11/23/21	\$90,000	3.000	\$10.01	05-070-013-00	3843 FRANKIE RD	05/17/21	\$150,000	0.189	\$10.14	05-122-065-00	1178 HEMINGWAY LN	03/22/21	\$260,000	0.191	\$1,085.85	05-184-034-00	876 INCOCHEE WOODS DR	07/08/21	\$385,000	0.385	\$1,015.65	05-307-075-00	2795 HIDDEN CREEK DR	09/10/21	\$524,000	0.437	\$1,342.42
05-007-014-15	4545 GALLAGHER DR	11/10/21	\$335,000	1.010	\$4.56	05-070-020-00	3761 FRANKIE RD	06/12/21	\$158,000	0.189	\$10.82	05-122-068-00	1154 HEMINGWAY LN	09/23/21	\$287,000	0.191	\$1,512.30	05-184-037-00	876 INCOCHEE WOODS DR	11/08/21	\$91,000	0.340	\$5.90	05-308-110-00	3873 STONERIDGE DR	12/23/21	\$542,100	0.630	\$8.63
05-008-003-00	4036 NORTH LONG LAKE RD	06/04/21	\$190,000	1.040	\$17.67	05-070-024-00	BROOK DR	02/24/21	\$22,500	0.189	\$7.73	05-122-076-00	1226 HEMINGWAY LN	11/09/21	\$287,000	0.191	\$1,679.79	05-184-048-00	630 INCOCHEE WOODS DR	10/10/21	\$95,000	0.345	\$6.32	05-308-118-00	3826 HIDDEN CREEK DR	07/30/21	\$525,000	0.359	\$1,419.19
05-008-008-00	4011 CEDAR RUN RD	02/09/21	\$220,000	1.108	\$2.63	05-070-043-00	3917 BROOK DR	03/19/21	\$165,000	0.189	\$7.65	05-123-001-00	4596 BARNES RD	01/04/21	\$249,260	0.820	\$2.41	05-186-050-00	INCOCHEE CREST COMMONS	08/28/21	\$250,000	1.061	\$5.41	05-313-017-00	4125 SUMMERHILL RD	07/23/21	\$485,000	0.360	\$1,117.07
05-008-010-00	CEDAR RUN RD	06/11/21	\$75,000	3.751	\$9.46	05-070-059-00	3902 BROOK DR	08/11/21	\$104,000	0.189	\$6.69	05-123-002-00	1607 BARLOW ST	09/29/21	\$205,000	0.325	\$6.18	05-188-043-00	1760 WOODWARD AVE	12/17/21	\$276,000	0.183	\$1,539.09	05-313-022-00	4294 SUMMERHILL RD	05/18/21	\$260,000	0.378	\$6.39
05-008-012-10	CEDAR RUN RD	09/22/21	\$300,000	5.500	\$50.42	05-070-061-00	3882 BROOK DR	12/21/21	\$185,000	0.189	\$13.51	05-128-011-00	2685 GREEN MEADOWS DR	02/02/21	\$142,000	0.175	\$4.45	05-188-044-00	1762 WOODWARD AVE	06/23/21	\$235,000	0.183	\$8.09	05-313-022-00	5136 STONERIDGE DR	11/12/21	\$688,000	1.040	\$6.25
05-008-027-21	4761 BARNES RD	07/30/21	\$262,500	0.700	\$4.24	05-070-064-00	3892 BROOK DR	02/02/21	\$178,000	0.189	\$13.12	05-128-018-00	2611 GREEN MEADOWS DR	02/16/21	\$139,000	0.160	\$9.18	05-210-014-00	1214 KNOLL CREST CT	07/19/21	\$235,000	0.158	\$8.57	05-316-055-00	1285 TERRACE BLUFF DR	04/27/21	\$248,000	0.222	\$6.29
05-008-033-00	4745 NORTH LONG LAKE RD	07/30/21	\$390,000	0.509	\$9.36	05-070-065-00	3842 BROOK DR	07/23/21	\$60,000	0.189	\$1.05	05-128-026-00	2701 GREEN MEADOWS DR	11/11/21	\$185,900	0.168	\$11.46	05-210-015-00	1226 KNOLL CREST CT	11/21/21	\$388,000	0.506	\$9.90	05-316-017-00	1346 TERRACE BLUFF DR	06/10/21	\$349,500	0.222	\$6.26
05-014-010-10	1123 OAK TRAIL	08/27/21	\$285,000	0.493	\$5.05	05-075-018-00	2465 W CARRIAGE HILL DR	04/14/21	\$205,000	0.245	\$4.92	05-128-033-00	2715 GREEN MEADOWS DR	08/16/21	\$195,000	0.160	\$13.06	05-210-022-00	1149 KNOLL CREST CT	08/20/21	\$280,000	0.284	\$1,020.00	05-316-022-00	1296 TERRACE BLUFF DR	01/22/21	\$232,500	0.222	\$4.47
05-014-011-10	1123 OAK TRAIL	08/25/21	\$277,000	0.495	\$6.73	05-075-034-00	2785 E CARRIAGE HILL DR	12/21/21	\$390,000	0.666	\$4.30	05-128-036-00	2715 GREEN MEADOWS DR	08/30/21	\$200,700	0.168	\$11.76	05-210-023-00	1123 KNOLL CREST CT	06/11/21	\$275,000	0.306	\$5.06	05-316-025-00	1224 TERRACE BLUFF DR	04/29/21	\$272,500	0.222	\$4.77
05-014-012-10	3871 BARNES RD	09/08/21	\$217,000	0.459	\$7.07	05-079-005-00	1232 TERRA RD	03/19/21	\$270,000	0.197	\$7.47	05-131-001-00	4314 BUTED DR	05/07/21	\$450,000	0.833	\$1.62	05-215-006-00	1662 LINDEN AVE	02/02/21	\$75,000	0.241	\$5.10	05-317-011-00	3914 CHERRY HILLS PL	09/02/21	\$272,000	0.243	\$1,121.01
05-014-013-00	3891 SILVER LAKE RD	04/02/21	\$225,000	0.535	\$8.85	05-079-022-00	1274 TERRA RD	02/05/21	\$251,800	0.197	\$7.29	05-131-016-00	GRAYHAWK BLVD	06/14/21	\$277,000	0.656	\$1.36	05-215-033-00	1649 LINDEN AVE	05/24/21	\$400,000	0.241	\$1.81	05-317-035-00	3717 EASTVIEW DR	11/29/21	\$400,000	0.243	\$1,817.11
05-014-015-00	4382 BARNES RD	11/02/21	\$300,000	2.550	\$9.80	05-079-035-00	1275 TERRA RD	11/02/21	\$302,000	0.197	\$7.43	05-131-035-00	4498 BUTED DR	12/29/21	\$1,240,000	0.652	\$2,045.45	05-220-007-00	3094 HORSHESHOE DR	09/24/21	\$255,000	0.438	\$5.21	05-317-037-00	3664 COUNTRYVIEW PL	09/30/21	\$296,000	0.243	\$1,184.84
05-014-022-00	3885 GADSDY DR	09/03/21	\$325,000	3.000	\$14.2	05-079-038-00	1295 TERRA RD	02/26/21	\$270,000	0.197	\$8.74	05-131-036-00	BUTED DR	09/07/21	\$277,000	1.086	\$9.07	05-223-006-00	5203 HAZELNUT CT	08/20/21	\$412,500	0.088	\$4,035.05	05-317-069-00	3694 EASTVIEW DR	02/22/21	\$360,000	0.243	\$1,171.76
05-014-023-10	3871 BARNES RD	06/20/21	\$142,500	2.920	\$5.43	05-082-002-00	2032 CHELSEA LN	02/19/21	\$239,000	0.185	\$12.98	05-131-039-00	4478 BUTED DR	08/19/21	\$211,000	0.812	\$5.79	05-223-011-00	4225 LONE PINE DR	06/18/21	\$41,000	0.121	\$7.78	05-317-081-00	3621 COUNTRYVIEW PL	01/21/21	\$270,000	0.243	\$9.49
05-014-028-00	3200 ZIMMERMAN RD	02/10/21	\$375,000	1.070	\$18.71	05-082-023-00	2325 WEXFORD DR	09/15/21	\$360,000	0.185	\$16.63	05-132-004-00	2185 HAMMOND PLACE CTR	03/22/21	\$515,000	0.214	\$8.38	05-223-011-00	5122 LONE MAPLE DR	08/30/21	\$480,000	0.088	\$7,124.00	05-318-013-00	908 SENNA ST	12/29/21	\$219,900	0.115	\$1,910.80
05-014-041-00	3235 ZIMMERMAN RD	03/12/21	\$340,000	1.100	\$3.32	05-082-030-00	2349 WEXFORD DR	03/31/21	\$280,000	0.185	\$12.08	05-132-017-00	2186 HAMMOND PLACE WEST	03/12/21	\$200,000	0.214	\$7.65	05-224-015-00	PINE MEADOW TRL	10/13/21	\$30,000	0.259	\$6.26	05-319-102-00	1291 LUMBER DR	10/01/21	\$274,900	0.288	\$2,214.84
05-014-044-00	3745 SILVER LAKE RD	09/24/21	\$325,000	1.030	\$3.13	05-082-033-00	2149 AVON DR	11/15/21	\$415,000	0.185	\$10.74	05-132-019-00	2196 HAMMOND PLACE WEST	04/26/21	\$198,000	0.214	\$7.80	05-224-024-00	LONE OAK DR	06/24/21	\$50,500	0.293	\$6.96	05-319-104-00	1277 WICA CT	10/01/21	\$380,000	0.403	\$2,211.65
05-014-046-00	3833 ZIMMERMAN RD	10/01/21	\$434,750	1.110	\$3.25	05-082-044-00	2147 AVON DR	10/19/21	\$405,000	0.185	\$13.95	05-132-026-00	947 HAMMOND PLACE SOUTH	11/30/21	\$267,800	0.214	\$15.78	05-224-033-00	5463 LONE BEECH LN	05/12/21	\$475,000	0.282	\$4.91	05-319-105-00	1285 WICA CT	10/11/21	\$376,000	0.323	\$2,676.72
05-014-048-00	NORTH LONG LAKE RD	09/14/21	\$1,475,000	54.490	\$50.63	05-091-001-00	2788 VICTORIA DR	01/08/21	\$219,485	0.277	\$4.66	05-132-034-00	2165 HAMMOND PLACE WEST	08/13/21	\$269,900	0.214	\$11.73	05-224-043-00	5463 LONE BEECH LN	01/29/21	\$490,000	0.291	\$3.54	05-319-168-00	1195 LUMBER DR	10/29/21	\$280,000	0.243	\$1,184.80
05-014-049-00	NORTH LONG LAKE RD	09/14/21	\$1,475,000	39.990	\$12.00	05-091-004-00	2546 WEST CROWN DR	07/12/21	\$975,000	0.236	\$32.56	05-132-038-00	2198 HAMMOND PLACE EAST	07/12/21	\$873,000	0.214	\$16.54	05-224-056-00	5320 LONE BEECH DR	06/23/21	\$660,500	0.309	\$1,831.01	05-319-169-00	1195 LUMBER DR	10/29/21	\$390,000	0.073	\$3,814.14
05-014-051-10	6037 HERRIN RD	08/05/21	\$350,000	2.639	\$14.4	05-093-007-00	2577 WEST CROWN DR	12/17/21	\$555,000	0.131	\$38.55	05-132-068-00	2051 HAMMOND PLACE EAST	10/08/21	\$279,900	0.214	\$12.71	05-224-057-00	5324 LONE BEECH DR	07/12/21	\$475,000	0.299	\$1,116.74	05-319-171-00	1171 LUMBER DR	04/30/21	\$290,000	0.074	\$1,615.75
05-020-024-10	2550 N EAST SILVER LAKE RD	06/18/21	\$425,000	2.920																									